

**PRODUCT SPECIFICATION**  
**LESGAZ DIVER'S GAS RECLAIM UNIT (SINGLE COMPRESSOR)**  
**Model: LME-RC-03-SHY**

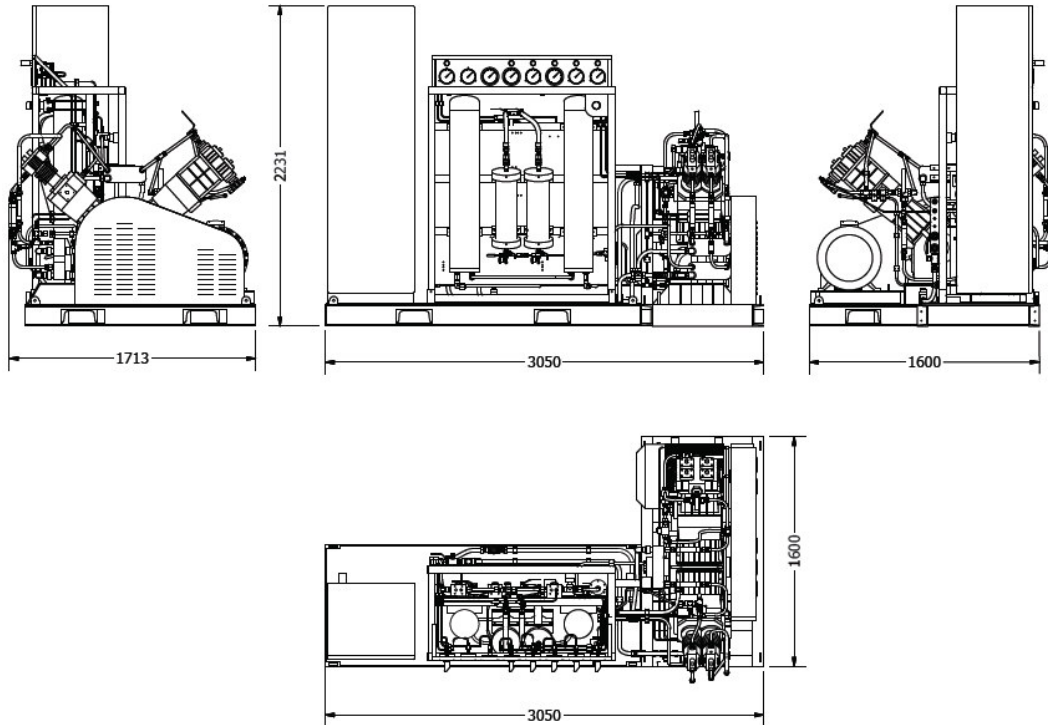

**Diver's Gas Reclaim Unit**  
**(Single Hycomp Compressor – 300m)**

The Diver's Gas Reclaim Unit consists of 3 basic units designed to re-cycle the Divers exhaled Gas.

The 3 units consist of:

- Processor
- Gas Management
- Internal & External Bell equipment

The return line Gas enters the Filter System, consisting of water trap and a series of micro particle and bacteria filters, where, the Oxygen Metabolic make-up takes place, the final filter is the CO<sub>2</sub> absorbent.

The scrubbed Gas returns to the Divers via the Volume Tank, Dive Control Panel and the Bell Panel. The Diver exhales directly to the internal Bell equipment where the correct negative pressure is maintained by the Bell BPR.

The Surface Processor, Booster & Electronic control units are mounted on a purpose built deck mounted skid. The Booster is controlled via a PLC system complete with incorporated alarms. The PLC is also fitted with an Eprom that will automatically re-set the PLC in the event of a Power failure.

The Booster is capable of supplying 200LPM to the Divers at a maximum depth of 300m (factory tested); however the unit is tested and approved to meet the DNV requirement of 135LPM for two divers at 300m.

The Gas Management Panel located in the Dive Control station and is fitted with 1 CO<sub>2</sub> and 1 Oxygen analysers monitoring the outgoing Gas through the Processor, the panel also controls the Oxygen Injection and the initial pressurisation of the system.

**Technical Data:**

Length:	3050mm
Width:	1713mm
Height:	2231mm
Weight:	2500kg
Power:	440V AC, 60Hz, 70Amps

Cooling Fluid:	Fresh Water
Input Flow:	20L/min @ 4-9bar (5gpm @ 58-130psig)
Temperature:	0 - 30 °C

Working Fluid:	He-O <sub>2</sub> (Helium-Oxygen Mix)
Output Flow:	180AL/min
Outlet Temperature:	max. 50 °C (99 °F)
Max Working Depth:	300 M.S.W.
Construction:	Steel/ Stainless Steel

Classification:	ABS, DNV
-----------------	----------